

Avalon Astoria Bay Insert Parts List

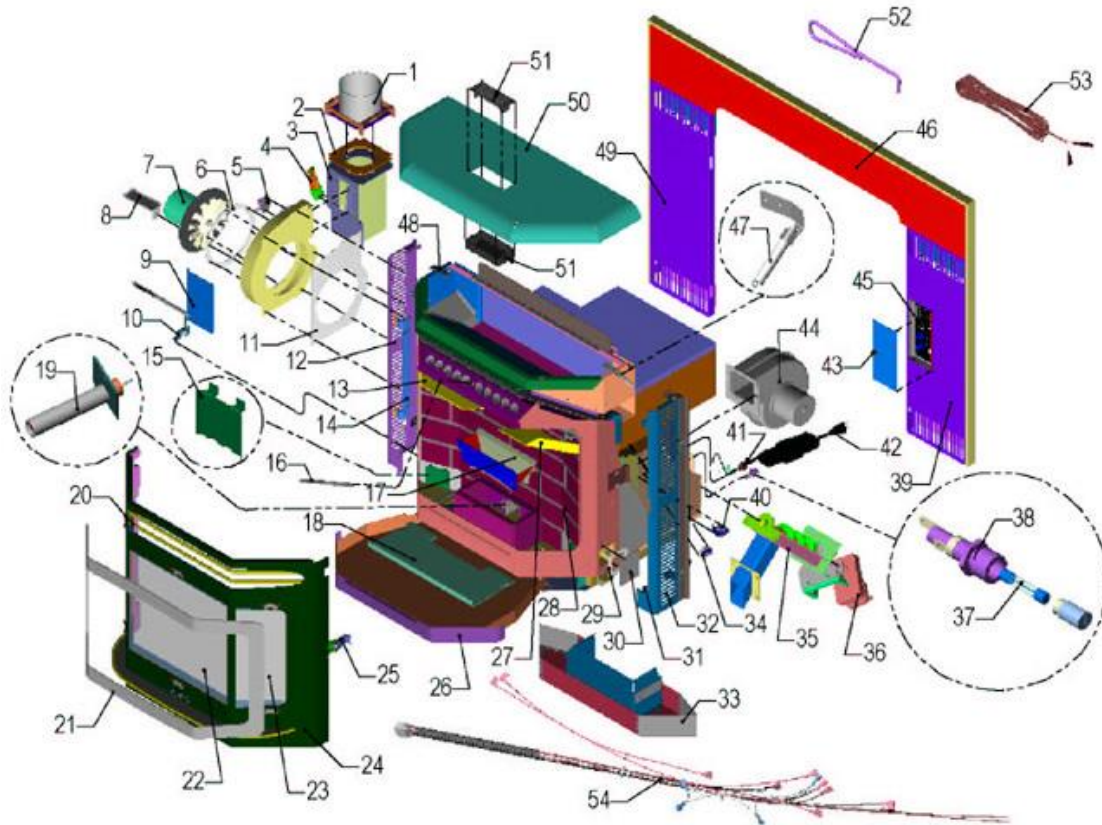

Item:	SKU:	Description:	Qty:
1	91002038	EXHAUST COLLAR WLD ASS'Y, AST	1
2	250-00363	GSKT, FLUE - LARGE PELLETT INS#	1
3	228-10031	FLUE ADAPTER ASS'Y, LRG PI	1
4	250-00392	DRAW LATCH, DOOR/FLUE	1
5	250-00313	SNAP-DISC - 120deg CERAMIC#	1
6	100-03231	GSKT, COMB BLOWER(MOTOR), LRG#	1
7	250-00538	BLOWER, COMB, PELLETT - LARGE#	1
8	210-03216	OIL PAN, COMB BLOWER - LG PEL	1

Woodman's Parts Plus  
[www.woodmanspartsplus.com](http://www.woodmanspartsplus.com)

9	221-22132	<b>DAMPER PLATE ASS'Y - AST/LRG-</b>	1	
10	221-22146	<b>CONTROL ROD CLAMP ASS'Y, LG PI</b>	1	
11	250-00357	<b>GSKT, COMB BLOWER (BODY), LRG#</b>	1	
12	223-22052	<b>PNL SIDE ASS'Y, LT - LG PI '02</b>	1	
13	250-00486	<b>FIREBOX BAFFLE, LEFT#</b>	1	
14	91002017	<b>HINGE PLATE ASS'Y, DOOR</b>	1	
15	93005054	<b>ASHTRAP DOORS, (x2) PS/PI#</b>	2	
16	250-00215	<b>SCRAPER ROD - HEAT TUBES#</b>	1	
17	99300171	<b>OBS BURNPOT, STANDARD LARGE</b>	1	
18	91002022	<b>ASH DUMP PLATE, LARGE PS/PI -</b>	1	
19	250-00243	<b>SEE 99300149</b>	1	
20	93005046	<b>GRILL, GOLD FRONT - AST/SAL#</b>	1	
21	91002006	<b>DOOR SHELL, ASTRIA PI/PS, BIK</b>	1	
22	91002004	<b>GLASS w/GASKET - AST/LPI FRONT</b>	1	
23	91002005	<b>GLASS w/GASKET - AST/LPI SIDE</b>	1	
24	224-11057	<b>DOOR, AVA, AST BAY '02, CMPLT</b>	1	
25	210-NF572	<b>DRAW LATCH w/BENT LEVER, P13</b>	1	
26	250-01387	<b>ASHPAN ASS'Y, LARGE PI '02 O/S</b>	1	
27	250-00485	<b>FIREBOX BAFFLE, RIGHT#</b>	1	
28	250-00536	<b>FIREBACK, CAST IRON LG PS/PI#</b>	1	
29	250-00362	<b>GSKT, CLEAN-OUT,AST/LG PI#</b>	1	
30	210-04395	<b>CLEAN OUT COVER</b>	1	
31	250-00002	<b>MAGNET w/OUT SHEATH</b>	1	

Woodman's Parts Plus  
[www.woodmanspartsplus.com](http://www.woodmanspartsplus.com)

32	221-12097	<b>ASHBOX, PELLET INSERT - LARGE</b>	1	
33	250-00009	<b>PANEL RT SIDE &amp; DR ASSY LG PI</b>	1	
34	250-00312	<b>SNAP-DISC - 120deg NO #</b>	1	
35	91002020	<b>AUGER ASS'Y - LARGE PELLET#</b>	1	
36	90-0191	<b>AUGER MOTOR, ALL PS/PI EXCEPT</b>	1	
37	93-0695	<b>FUSE, 5AMP, 5-PK #</b>	1	
38	250-00310	<b>FUSE HOLDER, w/o FUSE #</b>	1	
39	999-10003	<b>NOT AVAILABLE/ NOT A CS PART</b>	1	
40	250-00314	<b>SNAP-DISC - 200deg NC #</b>	1	
41	250-00300	<b>CORD RESTRAINER - LRG (BLACK)</b>	1	
42	250-00533	<b>POWER CORD, PS/PI 1997 &amp; UP</b>	1	
43	250-00374	<b>KNOB (PHENOLIC), 3/4" dia #</b>	1	
44	250-00588	<b>BLOWER, CONVECTION#</b>	1	
45	250-00011	<b>CNTRL BRD, ALL PEL 1997-2011#</b>	1	
46	999-10003	<b>NOT AVAILABLE/ NOT A CS PART</b>	1	
47	220-02042	<b>HOPPR SPRING PLATE ASS'Y, RT#</b>	1	
48	220-02041	<b>HOPPR SPRING PLATE ASS'Y, LT#</b>	1	
49	999-10003	<b>NOT AVAILABLE/ NOT A CS PART</b>	1	
50	220-02039	<b>HOPPER LID, LARGE PEL INSERT</b>	1	
51	250-00380	<b>HANDLE, HOPPER LID - BLACK</b>	1	
52	250-00345	<b>TOOL, GLASS LATCH/RESTRICTOR #</b>	1	
53	250-00780	<b>WIRE HRNS, THERMOSTAT (20')</b>	1	
54	250-00017	<b>WIRE HRNS, PEL, PS/PI 2005+#</b>	1	