

Scan A-10

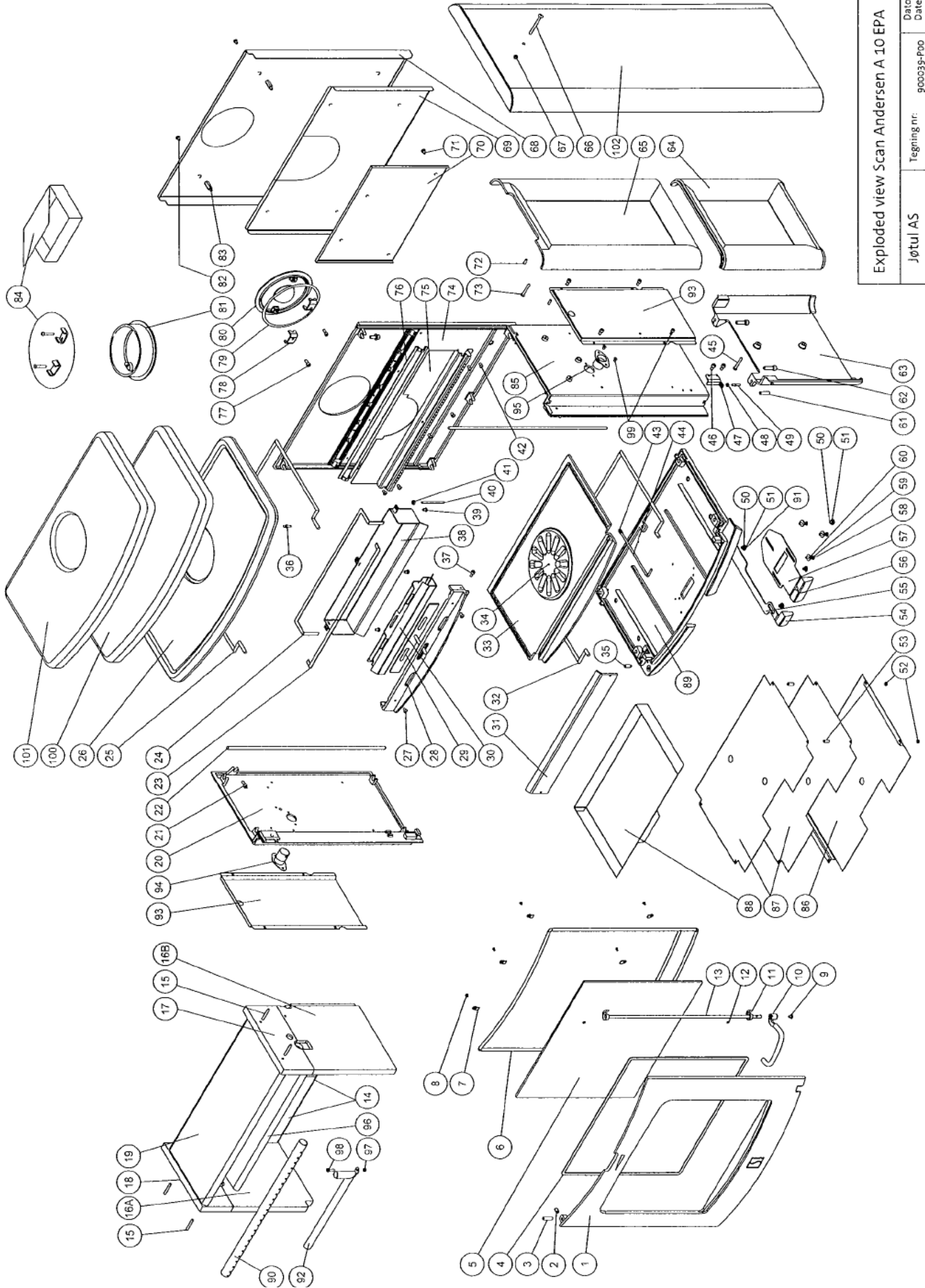

Exploded view Scan Andersen A 10 EPA

Jøtul AS Fredrikstad, Norway	Tegning nr: 900039-P00	Dato \ Date April 09
---------------------------------	---------------------------	-------------------------

Scan A-10

ITEM	PART #	DESCRIPTION
	351200	A-10, Matte Black Paint
		Accessory Items
	K228102	Soap Stone Side Kit
	156947	Soapstone Hardware, M6 x 60
	K51811001-091	Fresh Air Adapter
	361022	Soap Stone Top-Top Vent
	361023	Soap Stone Top-Rear Vent
1	156944	Door Complete w/out glass
2	118157	M6 x 5, socket screw
3	223065	Hinge Pin, straight
	223066	Hinge Pin, excentric
4	K55300023	Front Door Glass Gasket, 6 ft.
5	223051	Door Glass
6	K55200014	Door Gasket, 8 ft.
7	128361	Glass Clip, Jøtul type
	223037	Glass Clip, Scan type
8	117505	Screw, M6 x 8 Pan Head
9	TBA	
10	TBA	
11	222805	Hook for closing mechanism
12	TBA	
13	223052	Door Closing Rod Complete w/ hooks
14	223056	Skamol, rear, left and right (need 2)
15	223049	M6 x 40 Baffle Pin
16A	223183	Skomal, Left Lower Side
16B	223181	Skomal, Right Lower Side
17	223184	Skamol, Right Upper Side
18	223182	Skamol, Left Upper Side
19	223186	Skamo, Upper Baffle
20	10478992	Sideplate, Left
21	117876	M8 x 25 Hex Cap Flange Screw
22	K55300014	Gasket, 2 ft.
23	K55300014	Gasket, 3 ft.
24	K55300023	Type X gasket, 3 ft.
25	K552000014	Type N Gasket 6 ft.
26	10452392	Top Plate, MB
27	117857	5m x 16 Counter sunk screw
28	10451692	Air Front Piece, MB
29	223073	Air Valve, Upper air control
30	223074	Air Deflector
31	223067	Ash Retainer
32	223083	Shaker Grate Rod
33	10452412	Inner Bottom Plate
34	10457618	Shaker Grate
35	223064	Stop for Door
36	223085	Locking Pin (Upper Door Latch Pin screws into Top Plate
37	99625	M6 x 16 Hex Head Flange Bolt
38	223072	Secondary Air Box, Deflector
39	117505	M6 x 8 Pan Head Screw
40	118162	M6 x 82 Threaded Bar
41	117968	M6 Hex Cap Nut
42	117505	M6 x 8 Pan Head Screw
43	118161	5m Hex Cap Nut
45	117856	M6 x 40 Counter Sunk Cap Screw
46	9962	M6 x 10 Hex Head Bolt
47	223079	Bracket for Lower Door Latch Locking Pin
48	118161	5m Hex Cap Nut
49	223087	Locking Pin (Lower Door Latch Pin)
50	223044	Bushing, Start Up Air

Scan A-10

ITEM	PART #	DESCRIPTION
51	117130	M6 x 12 Hex Head Flange Bolt
52	117880	M6 Hex Cap Nut
53	126109	10mm Sleeve
54	10475118	Shaker Grate Handle
55	223070	Shaker Grate Connector
56	10457918	Handle, Start up Air
57	223418	Start Up Air Valve
58	118160	M6 x 25 Flat Head Hex Socket Screw
59	223045	Spring, Start Up Air
60	120004	M6 Fender Washer
61	117774	M6 x 16 Set Screw
62	118092	M6 x 25 Socket Head Cap Screw
63	10452592	Inner Leg, Single Piece, MB
64	10456692	Convection Side, Lower, MB
65	10456592	Convection Side, Upper, MB
66	156947	Soapstone Hardware Kit
67	117968	M6 Hex Cap Nut
68	223425	Rear Heatshield, Otter, MB
69	223077	Rear Heatshield, Inner, MB
70	223414	Air Box, Rear
71	99625	M6 x 16 Hex Head Flange Bolt
72	117774	M6 x 16 Set Screw
73	99625	M6 x 16 Hex Head Flange Bolt
74	10452192	Rear Plate, MB
75	223084	Rear Air Chamber
76	K55200007	Flat Gasket, 3 ft.
77	117731	M6 x 20 Socket Head Bolt
78	223001	U-Clamp for smoke outlet cover
79	K55200007	Gasket, 3 ft.
80	10457892	Smoke Outlet Cover, MB
81	10458792	Smoke Outlet, MB
82	117505	M6 x 8 Pan Head Screw
83	118155	Standoff, Hex Body 25mm
84	156695	Mics. / Hardware Kit Stove Box
85	10478892	Right Inner Sideplate, MB
86	223076	Bottom Heatshield, lower
87	223075	Bottom Heatshield, upper
88	223060	Ash Pan
89	10451792	Bottom Plate, MB
90	223419	Secondary Air Tube
91	120004	M6 Fender Washer
92	223417	Pilot Air Tube
93	223413	Air Inlet Box, side
94	223415	Secondary Air Tube End, Left (Long)
95	223416	Secondary Air Tube End, Right (Short)
96	223185	Skomal Baffle, lower
97	9930	M6 Hex Nut
98	117703	M6 x 16, Socket Head Screw
99	118170	M6 x 6 Socket Head Screw