

**HearthStone**<sup>®</sup>  
Quality Home Heating Products

**MANSFIELD I WOOD STOVE  
EXPLODED PARTS DRAWING**

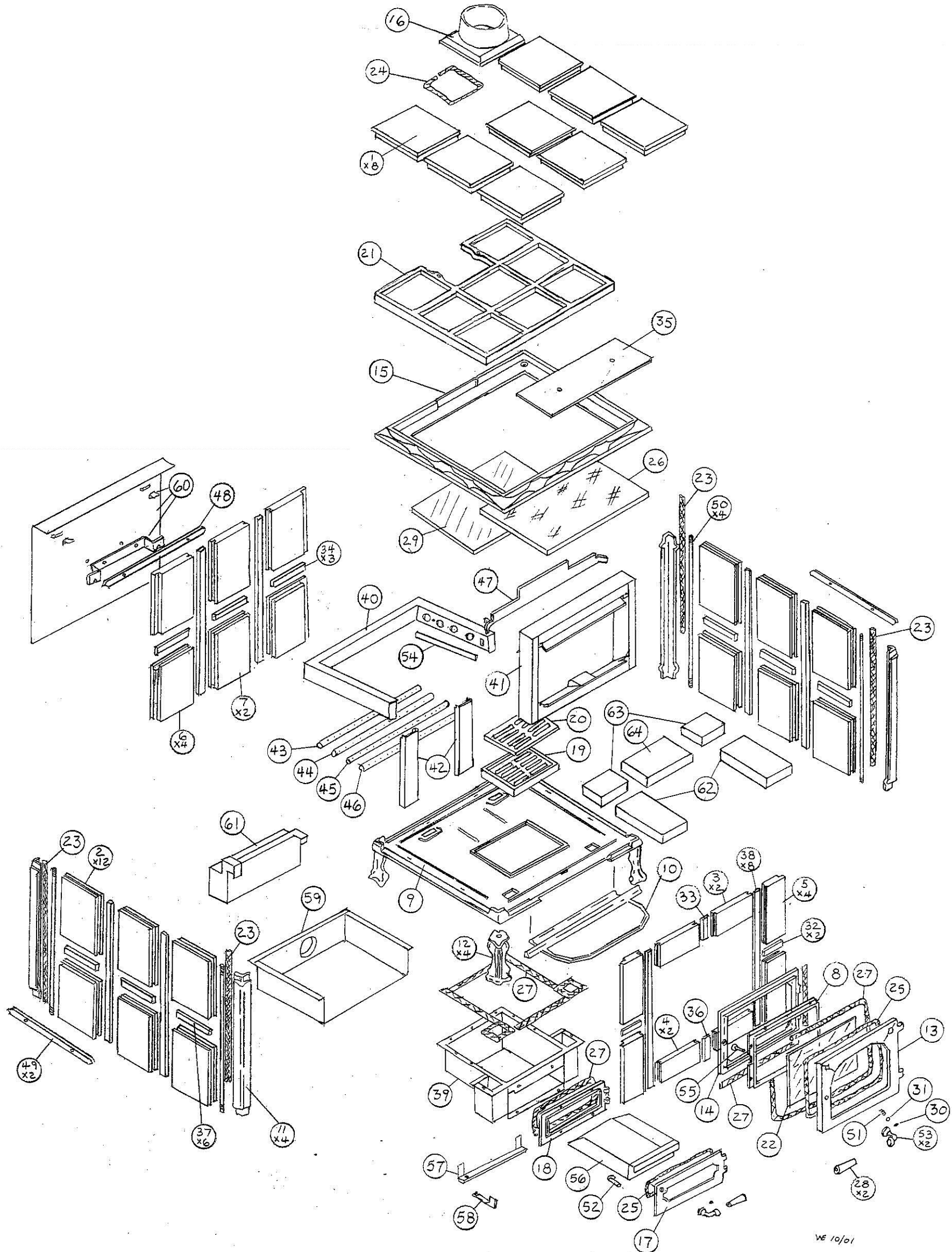



S O A P S T O N E

Model: Mansfield Model #8011

Production Dates: November 1999 - June 2011

Serial #: 000001 (per ECO#2658) - 011959

Note: Color must be specified for cast iron parts which are available in enamel.

Key	Part #	Description
1	1141-260	Top Stone 8-1/32" x 7"
2	1141-226	Side Stone 6-3/8" x 9-1/2"
3	1141-251	Front Top Stone 2-3/4" x 9-1/2"
4	1141-252	Front Bottom Stone 3-3/4" x 9-1/2"
5	1141-254	Front Corner Stone 2-19/32" x 9-1/2"
6	1141-255	Rear Corner Stone 8-1/32" x 9-1/2"
7	1201-26	Rear Center Stone 8" x 9-1/2"
8	2010-550	Glass Retention Frame
9	2010-101	Bottom Casting
10	2010-200	Ash Lip
11	2010-300	Corner Post
12	2510-303	Foot
13	2010-500	Front Door
14	2010-602	Front Door Exterior Frame
15	2010-801	Top Casting
16	2010-900	Flue Collar
17	2010-060	Ash Door
18	2010-050	Ash Door Frame
19	2010-150	Ash Grate Frame
20	2010-160	Ash Grate Top
21	2010-851	Top Stone Support Grid
22	<b>90-57005</b>	<b>Front Door Glass Kit (includes following pt#s)</b>
	3030-026	IR Glass 11 3/16" x 17 9/16" x 5mm
	3160-080	3/4"x 1/16" Gasket Tape - 5'
23	3110-063	3/4" Rope Gasket
25	<b>90-57001</b>	<b>Gasket Kit (includes following pt#s)</b>
	3110-057	3/8" Non-core Gasket Rope - 5'
	3110-059	3/8" Med Density Gasket Rope - 3'
	3160-080	3/4"x1/16" Gasket Tape - 5'
	99-090N	2 oz. Gasket Glue
26	3120-201	Ceramic Blanket

<b>28</b>	<b>90-71100</b>	<b>Wooden Handle Assembly (includes following p</b>
	3900-177	Wood Handle
	4500-1680	1/4-20 x 3-1/4" Bolt
	4600-0400	1/4" Lock Washers
29	3120-202	Ceramic Baffle Board
32	5000-001	Stone Spline 1/8"x3/4"x1-1/4"
33	5000-002	Stone Spline 1/8"x3/4"x2-1/2"
34	5000-008	Stone Spline 1/8"x3/4"x6-7/8"
35	5010-450	Top Heat Shield
36	5000-2236A	Stone Spline 1/8"x3/4"x3-7/8"
37	5000-2236B	Stone Spline 1/8"x3/4"x5-1/4"
38	5000-2236C	Stone Spline 1/8"x3/4"x19"
39	5010-051	Air Intake/Ash Box
40	5010-101	Secondary Air Manifold
41	5010-201	Primary Air Manifold
42	5010-221	Secondary Air Riser Tubes
43	5010-255	Secondary Air Tube (Rear)
44	5010-256	Secondary Air Tube (Rear Center)
45	5010-257	Secondary Air Tube (Front Center)
46	5010-258	Secondary Air Tube (Front)
47	5010-301	Baffle Support
48	2010-170	Stone Trim
49	1141-205	Top Stone 8-1/32" x 14-1/32"
50	5210-2325	Threaded Rod 3/8"-16 x 22"
<b>52</b>	<b>90-73116</b>	<b>Ash Door Latch Assembly (includes following p</b>
	4500-2976	Set Screw
	5010-081	Crank Handle
	5010-057	Door Latch
	4700-0790	Door Latch Spacers
	5021-032	Flat Washer
	5240-138	Latch Spring
<b>53</b>	<b>90-73112</b>	<b>Front Latch Assembly (includes following pt#s)</b>
	4500-2976	Set Screw
	4700-0790	Door Latch Spacers
	5010-078	Door Latch
	5010-081	Crank Handle
	5021-032	Flat Washer
	5240-138	Latch Spring
54	5010-260	Secondary Air Pipe Retention Clip
56	5010-060	Ash Pan
57	5010-070	Primary Air Control Slide
58	5012-057	Primary Air Control Handle
62	1-0000-101	Firebox Side Stone (Front)

- 63 1-0000-100 Firebox Side Stone (Rear)
- 64 1-0000-102 Firebox Side Stone (Center)

Updated 8/01/17