

Compatibility

AGP Insert – SKU 99800521

Packing List

(2) Side Panels (left and right side)

Installation Instructions



Unplug the heater and make sure it is fully cool prior to conducting service.

Hints for Working with Stainless Steel Panels

The optional stainless steel panels are susceptible to finger prints and other marks. We suggest you peel the protective coating up from the corners and edges of the panels before installing. After the panels are installed, remove the protective coating. This allows you to handle the panel without leaving marks. Any marks on the panel may be cleaned using a dry soft cloth (you may also use a stainless steel cleaner). Always wipe the surface in the same direction as the brushed finish.

- 1 The insert should be in position with surround panel attached prior to attaching the side panels.
- 2 The side panels attach to the side of the insert with two screws on each side. Brackets on the panels slide over the screws. Make sure the screws are loosened 4 or 5 turns prior to installing.



NOTE: When installing, make sure the tabs on the panel insert into the slots on the front of the insert

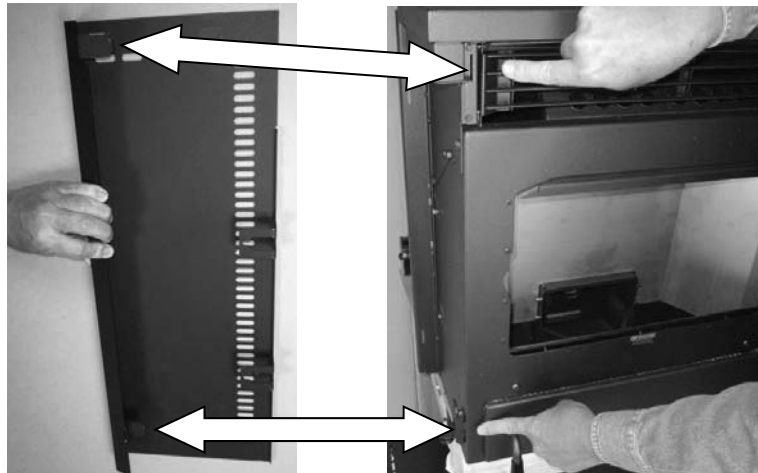



TRAVIS INDUSTRIES
HOUSE OF FIRE

AGP Insert Side Panels

(94400030, 94400031, 94400032)

- 3 Tighten the the two screws on each side to secure the side panels. The screwdriver fits into the cooling slots on the side panels.



Hand-Rubbed Patina Finishes

The optional patina finish is hand applied by a skilled artisan to permanently alter the colors and texture of the metal. Each piece is individually hand-polished and fired in an oven which imparts unique color subtleties with no two finishes alike. The patina finish is a "living" color and will age and antique over time.