

4237 Traditional Log Set Installation Instructions (SKU 94500980)

Packing List

- 11 Logs

Included With Fireplace

- Stainless Steel Wool
- Bag of Ember Chunks
- Bag of Rock Wool

Log Set Installation

1. Stretch the stainless steel wool to a thin gauze-like layer.



2. Place the steel wool over the center air channel, between the burners. It should be tucked under the burners.

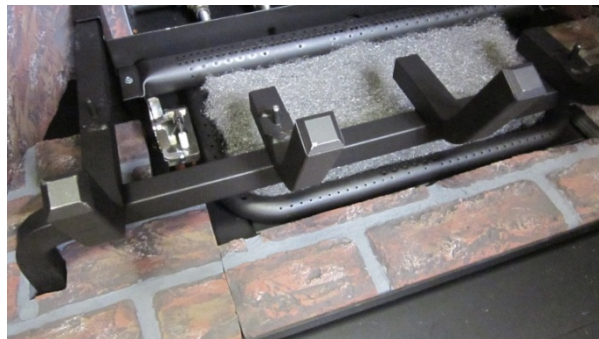

3. Place 1 bag of ember chunks over the stainless steel. The chunks should not cover the burner or any of its ports.



4237 Traditional Log Set Installation Instructions (SKU 94500980)

- Place the remaining ember chunks over the floor of the firebox as shown below. The chunks should not cover the burner or any of its ports.



- Tear small chunks of rock wool and place them over the burner as shown below. They should form a loose layer over the burner that allows for air to pass through. **USE THE ENTIRE BAG OF EMBERS.**



4237 Traditional Log Set Installation Instructions (SKU 94500980)

6. Install the lower rear log as shown below. Make sure the front edge of the log fits behind the center air deflector.

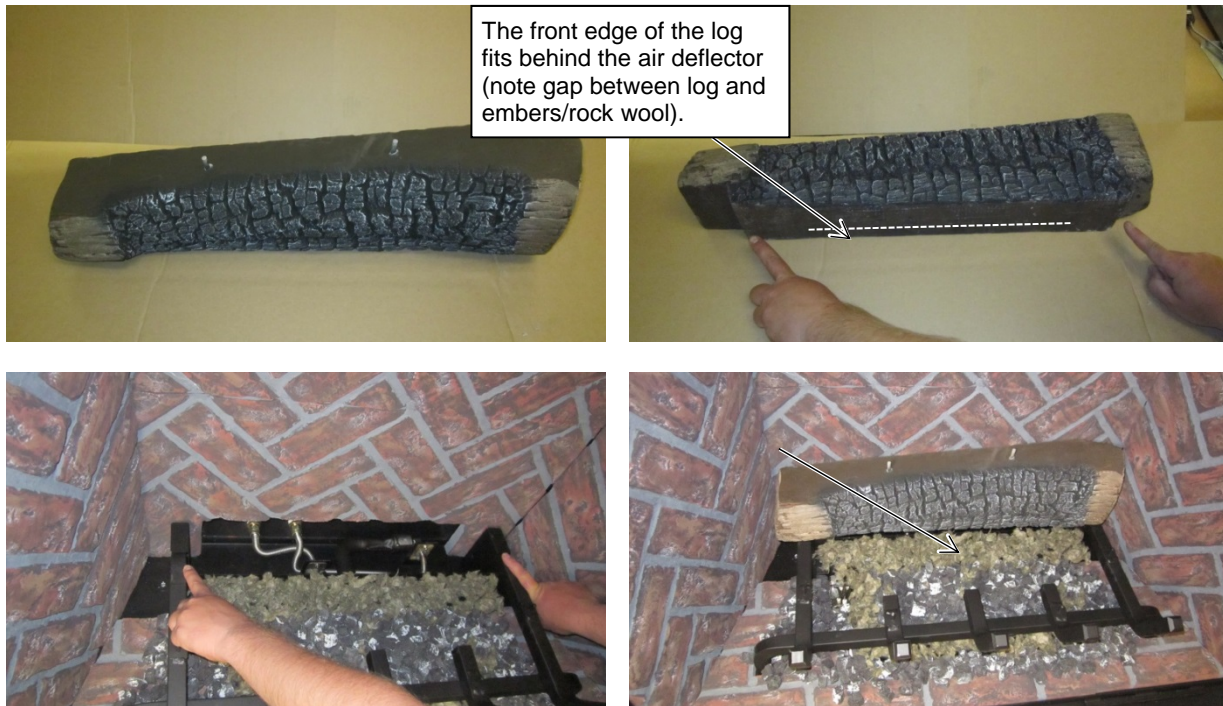

NOTE: The rear lower log may be moved forward or back. Make sure it has a small gap to the embers/rock wool.



4237 Traditional Log Set Installation Instructions (SKU 94500980)

7. Install the upper rear log as shown below.



8. Install the right ember as shown below.



4237 Traditional Log Set Installation Instructions (SKU 94500980)

9. Install the front twig as shown below.



10. Install the left twig as shown below.



4237 Traditional Log Set Installation Instructions (SKU 94500980)

11. Install the left ember as shown below.



12. Install the left log as shown below.



4237 Traditional Log Set Installation Instructions (SKU 94500980)

13. Install the center twig as shown below.



14. Install the right twig as shown below.



4237 Traditional Log Set Installation Instructions (SKU 94500980)

15. Install the right log as shown below.



16. The log set, when installed should look as shown below.

